

Max. 450 mm.

SECTION A-A

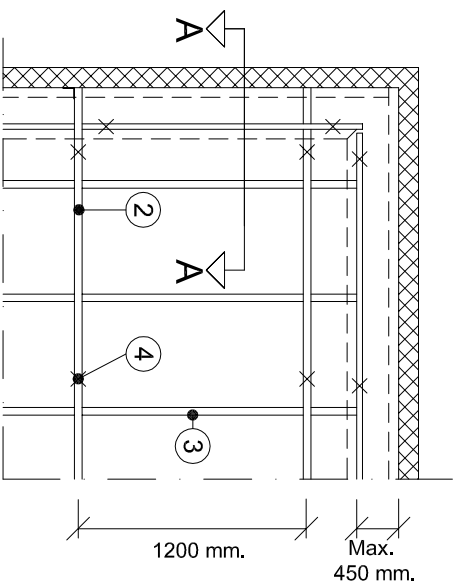

Max.
450 mm.

Max.
600 mm.

Max.
450 mm.

1200 mm.

PLAN CUTOUT

- 1 24x24 mm wall angle attached to GK main channel, with screws c/c 300 mm
- 2 24 mm main beam Cross-Lock Unipro, with c/c distance 1200 mm, continued to the wall.
- 3 24 mm cross profile Cross-Lock Unipro, c/c distance 600 mm.
- 4 Adjustable hanger c/c distance 1200 mm, but first hanger no more than 300 mm from wall angle.
- 5 Cross Lock Connector, c/c distance 600 mm.
- 6 Bracket for connection between wall and grid system at every 2. main beam.
- 7 12,5 mm Gyptone tiles with edge D2 (perforated / non perforated).
- 8 Edge rail KS 13.
- 9 Main channel GK-1.
- 10 Adjustable hanger GK 26-27/GK 27, c/c distance 900 mm.
- 11 Steel angle H 50/50, attached to wall at 400 mm. with screw with pan-head.
- 12 Gyproc screw QSTR 25, cc distance 300 mm
- 13 12,5 mm Gyproc plaster board Gyptone BIG Base (joining supportes with steel base plate and fillers/screws).
- 14 Wall spring, 2 pcs. for each tile

STANDARD DETAIL

System Gyptone edge D2 ceiling

Notation Frieze with GK system and D2 system, max frieze width 450 mm.

Scale

1:2

Date

20/04-2015

Rev.

Rev. date

Nr.

D2-002

GYPTONE