

It may be an advantage to use a wooden moulding when attaching the wall angle in order to absorb possible unevennesses of the wall.

- 1 Shadow moulding 4140017, attached to wall at 300 mm with screw with pan-head.
- 2 15 mm main T section 4120180, with cc distance 1200 mm.
- 3 15 mm Cross T section 4120163, length 1200 mm, cc distance 600 mm.
- 4 Adjustable hanger with cc distance 1200 mm.
- 5 Adjusted Cross T section.
- 6 10 mm Gypstone plaster board with edge E15 (perforated / not perforated).
- 7 15 mm Cross T section 4120161, length 600 mm, cc distance 1200 mm.

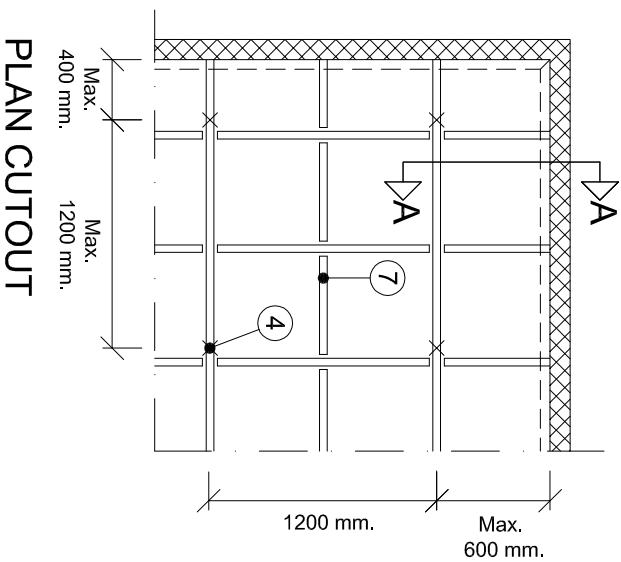

STANDARD DETAIL

System Edge E15 ceiling

Notation Wall attachment with shadow moulding, max. frieze with 600 mm.

Scale 1:2 Date 25/07-2012 Rev. Rev. date



Nr. E-001-10mm