

### SECTION A-A

- 1 15 mm main T section 4120180, cc distance 1200 mm.
- 2 15 mm Cross T section 4120163; length 1200 mm, cc distance 600 mm.
- 3 Adjustable hanger, cc distance 1200 mm.
- 4 Gypstone 10 mm plaster board with edge E15 (perforated / not perforated).
- 5 Perimeter channel GK-C, attached to wall at 400 mm.
- 6 Adapted main channel GK 1, cc distance max. 400 mm.
- 7 12,5 mm adapted frieze of FP-13E (edge E15 from factory). (Joining supports with steel base plate and fillers/screws).
- 8 Gyproc screw QS 25, placed with c/c distance 300 mm.
- 9 Gyproc screw QS 25, placed with 1 pr. for each adapted GK 1 profile.
- 10 Cross T section 4120161 (15 mm.), length 600 mm. cc distance 1200 mm

### STANDARD DETAIL

System	Edge E15 ceiling
Notation	Attached frieze with edge E15, frieze width max. 600 mm.



Scale	1:2	Date	25/07-2012	Rev.		Rev. date		Nr.	E-005-10mm
-------	-----	------	------------	------	--	-----------	--	-----	------------

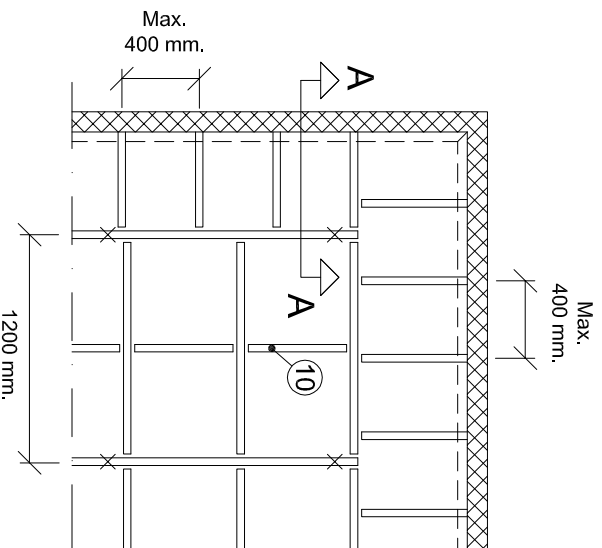

### PLAN CUTOOUT